

LOCATION NOTICE--LODE

KNOW ALL MEN BY THESE PRESENTS: That

C.M. Bathey,
Harrel Allred, Charles J. Parker the
locators

having discovered this mineral lode, vein, or deposit within the claim hereby located, claim by right of discovery and location all Uranium, Thorium, and other fissionable materials plus Vanadium, Manganese and other non-fissionable associated minerals, under and in accordance with the provisions of the Act of Congress of May 10, 1872 and the laws of the State of Wyoming for mining purposes 1500

feet in length along or on this mineral lode, vein, or deposit at the surface; together with all dips, spurs, angles and variations; also all water rights incident and appurtenant. Said claim is situated in Sublett County, State of Wyoming, and is bounded and more particularly described as follows, to-wit:

Beginning at a point which is 4000 feet in direction East thence 1500 NE.
from along HOT HILL #1 claim side 1 & 2 corners to HOT HILL #2 CORNER #1

thence 1500 feet in direction NE;

thence 600 feet in direction SE;

thence 1500 feet in direction SW;

thence 600 feet in direction NW to point of beginning.

The discovery monument lies midway between the two sides and is 300 feet in direction SE, FROM CENTER OF SIDE, BETWEEN CORNERS MARKED 1 AND 2 from SEC. 14 T. 32 N., R. 106 W.,
OF HOT HILL CLAIM #2 IN
 6th P.M., Wyoming.

This claim shall be known as HOT HILL #2.

The undersigned intend(s) to hold and work said claim by the local customs and rules of miners and of said Mining Statutes of the United States and the State of Wyoming.

The location of this claim in relation to adjoining claims is as follows:

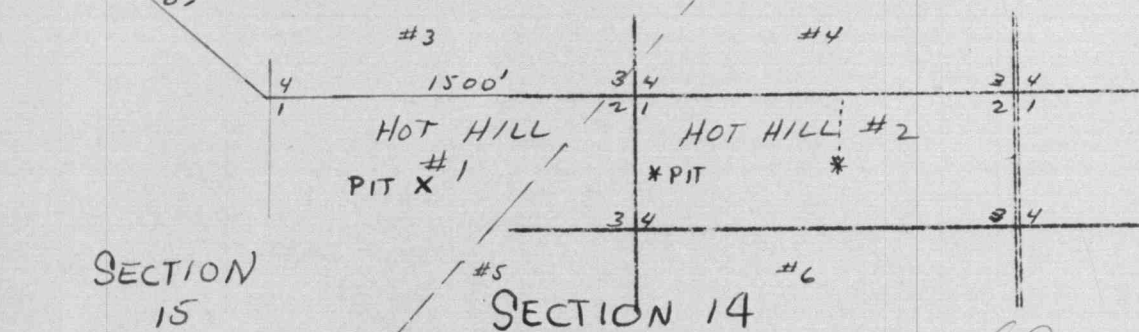

Witness

C.M. Bathey Witness

Witness

Witness

C.M. Bathey Locator

Harrel Allred Locator

C.J. Parker Locator

Dated on the ground, this 30 day of April 1955.

Discovered April 30 Recorded _____

ATTEST _____