

NOTICE OF LOCATION

NOTICE IS HEREBY GIVEN, That the undersigned, having complied with the requirements of SECTION 2324 of the REVISED STATUTES of the United States, and the Local Laws, Customs and Regulations of this District, have located Fifteen hundred feet in length by Six hundred feet in width, on this the _____
Uranium, Vanadium, Manganese, Potash _____ Lode, Vein or Deposit, bearing
Gold, Silver, Copper, Lead or other valuable minerals, situated _____
Northerly of and joining onto Claim # 3 _____

in the _____ Mining District,
_____ Klondyke
_____ Sublette _____ County, State of Utah
_____ Yukon

the location being described and marked on the ground as follows, to-wit:
Beginning 00 feet Southerly of this Location (Discovery)
Monument, at the 750 Southern end center monument, and running
thence Westerly 300 feet to S. W. corner monument No. 1;
thence Northerly 1500 feet to N. W. corner monument No. 2;
thence Easterly 300 feet to Northern end center monument;
thence Easterly 300 feet to N. E. corner monument No. 3;
thence Southerly 1500 feet to S. E. corner monument No. 4;
thence Westerly 300 feet to place of beginning; including all Dips, Spurs,
Angles or Variations _____

The above described Mining Claim shall be known as the
Pine Dale # 4

Located this 18th day of July 19⁵⁵

RECORDED August 4, A. D. 1955 11:00 A. M.
IN BOOK 2 A. Loc. Notices. PAGE 255.
FEES \$ 1.40
SUBLETTE COUNTY PINEDALE, WYOMING

53733

NOTE.
*The small type below blank lines is merely a guide for the locator and is no part of this notice.
† DIAGRAM OF CLAIM—The location (discovery point) and corner monuments should be designated on the accompanying diagram to make the Record of claim more perfect.
A mining claim must not exceed 1500 feet in length along the vein or lode, by 600 feet in width 300 feet on each side of center of vein at surface.
No location of a mining claim can be made until the discovery of the vein or lode within the limits of the ground claimed.
The claim must be distinctly marked on the ground so its boundaries can be readily traced.
A severe penalty is provided by law for removing or defacing the stakes or monuments of a mining claim.
Claims located on Sunday or holidays are legal.
All valuable mineral deposits in lands of the Government are locatable by citizens of the United States only, and those who have declared their intentions to become such.
This location notice must be filed for Record with the District Recorder if the property is in a mining district; if there is no district it should be filed with the County Recorder of the county in which the claim is located.
\$100 must be expended on each unpatented claim annually (and Notice posted); but, in a group of several claims, the work may be performed on any one providing it tends to develop them all.

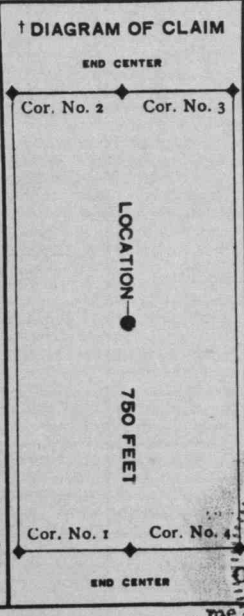

NAMES OF LOCATORS:

Woodrow New
T. C. Midgley
T. C. Midgley

STATE OF UTAH
COUNTY OF SALT LAKE
On the 18th day of JULY 19⁵⁵ Personally appeared before me _____ who signed the foregoing instrument and duly acknowledged to me that he executed the same.
My Comm. Expires 12/21/57
Notary Public Residing Salt Lake City