

NOTICE OF LOCATION

NOTICE IS HEREBY GIVEN, That the undersigned, having complied with the requirements of SECTION 2324 of the REVISED STATUTES of the United States, and the Local Laws, Customs and Regulations of this District, ha located Fifteen hundred feet in length by 600 feet in width, on this the Sal Haro #1 Lode, Vein or Deposit, bearing Gold, Silver, Copper, Lead and other valuable minerals, situated Approximately one mile north of Tosi Creek in T39N, R41W, IN NORTH FORK OF DRY CANYON, SFS Section 17; and approximately 4 miles east of Double top peak in the Unknown Mining District,

Sublette County, State of Wyoming, the location being described and marked on the ground as follows, to-wit:
Beginning 750 feet SW of this location (Discovery) Monument, at the SW end center monument, and running thence NW 300 feet to W corner monument No. 1; thence NE 1500 feet to NW corner monument No. 2; thence SE 300 feet to NE end center monument; thence SE 300 feet to E corner monument No. 3; thence SW 1500 feet to SE corner monument No. 4; thence NW 300 feet to place of beginning; including all Dips, Spurs, Angles and Variations — this claim adjoins Sal Haro claim #2, which is on the NW side

The above described Mining Claim shall be known as the

Sal Haro #1

Located this 11 day of September 1955

Note.

*The small type on blank lines is merely a guide for the locator and is no part of this notice.

†DIAGRAM OF CLAIM—The location (discovery point) and corner monuments should be designated on the accompanying diagram to make the Record of claim more perfect.

A mining claim must not exceed 1500 feet in length along the vein or lode, by 600 feet in width, 300 feet on each side of center of vein at surface.

No location of a mining claim can be made until the discovery of the vein or lode within the limits of the ground claimed.

The claim must be distinctly marked on the ground, so its boundaries can be readily traced.

A severe penalty is provided by law for removing or defacing the stakes or monuments of a mining claim.

Claims located on Sunday or holidays are legal.

All valuable mineral deposits in lands of the Government are locatable by citizens of the United States only, and those who have declared their intentions to become such.

This location notice must be filed for Record with the County Recorder of the county in which the claim is located.

† DIAGRAM OF CLAIM.

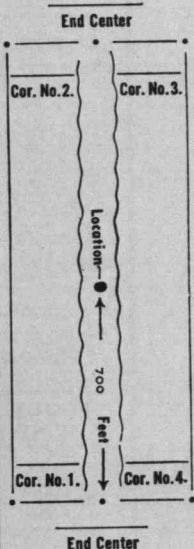

NAMES OF LOCATORS:

Salvatore F. Piparato

Harold C. Gradwohl

The State of Wyo.) ss

Co. 3 Sublette)

Subscribed & sworn to before me this 13th day of Sept. 1955-

St. J. Summers, Co. Clerk
By Hazel P. Bloom, Deputy

54127

BLANK NO. 23—ARROW PRESS, 62 W. SECOND SOUTH, SALT LAKE

RECORDED September 13, 1955 4:30 A M
IN BOOK 2A Sec. Nat. PAGE 375
FEES \$ 1.00 St. J. Summers COUNTY CLERK
SUBLETTE COUNTY, PINEDALE, WYOMING