

56559

RECORDED July 20 1956 at 4:50 P. M
 IN BOOK 3A Loc. Notices PAGE 168
 FEES \$ 1.00 Wm Summers COUNTY CLERK
 SUBLETTE COUNTY, PINEDALE, WYOMING

LOCATION NOTICE -- LODE

KNOW ALL MEN BY THESE PRESENTS: That

Ed Pinchcitizen George S. Smith of the United States, over the age of twenty-one years and residingin the County of Sublette and State of Wyoming,having discovered a vein or lode of quartz, or rock in place, bearing molybdenum

and all Precious Metals within the claim hereby located, claim by right of discovery and location, under and in accordance with the Revised Statutes of the United States, Chapter 2, Title 30, and amendments thereto, and the laws of the State of Wyoming

1500 feet linear and horizontal measurement along the vein or lode

thereof, with all its dips, variations and angles, together with feet in width on each side of the center of the discovery shaft, or discovery workings; and all veins, lodes, ledges, deposits and surface grounds within the lines of said claims and within the operation and affect of said U. S. Revised Statutes

and Wyoming Statutes. Said claim is situated in Unorganized

Mining District, County of Sublette and State of Wyoming, and is bounded and more particularly described as follows, to-wit:

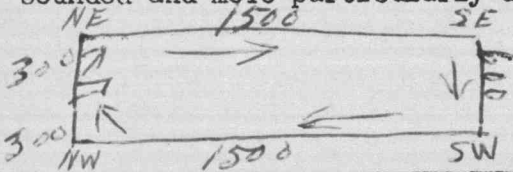

and that a discovery shaft has been sunk thereon, and that the point of discovery and the surface boundaries have been marked in accordance with Chapter 70, Wyoming Revised Statutes, 1931, and amendments thereto.

The claim will be known by the name of Temple Creek 43.

And intend to hold and work said claim by the local customs and rules of miners and of said Mining District and the Mining Statutes of the United States and the State of Wyoming.

Witness

Ed Pinch Locator.George S. Smith Locator.Dated on the ground, this 12 day of July, 1956.Discovered July 12, 1956Recorded ATTEST:

THE STATE OF WYOMING)
 County of Sublette) ss

George S. Smith, being duly sworn, says:

That he is of lawful age and one of the locator and claimant of the foregoing described mining claim; that said location was made in good faith; and that the matters set forth in the foregoing Notice of Location by him described are true; and that notice of said location was posted at the point of discovery upon said claim on the 12th day of July A.D. 1956.

Subscribed and sworn to before me this 20 day of July A.D. 1956My Commission expires Jan. 5-59Wm Summers County ClerkBy Hazel D. Bloom, Deputy