

# NOTICE OF LOCATION

NOTICE IS HEREBY GIVEN, That the undersigned, having complied with the requirements of SECTION 2324 of the REVISED STATUTES of the United States, and the Local Laws, Customs and Regulations of this District, ha located Fifteen hundred feet in length by 600 feet in width, on this the Valuable Minerals Lode, Vein or Deposit, bearing Gold, Silver, Copper, Lead and other valuable minerals, situated

in the Unknown Mining District, Sublette County, State of Wyoming, the location being described and marked on the ground as follows, to-wit:

Beginning at this feet of this location (Discovery) Monument, at the NW end center monument, and running thence NE 300 feet to N corner monument No. 1; thence SE 1500 feet to E corner monument No. 2; thence SW 300 feet to SE end center monument; thence SW 300 feet to S corner monument No. 3; thence NW 1500 feet to W corner monument No. 4; thence NE 300 feet to place of beginning; including all Dips, Spurs,

Angles and Variations T 29 N, R 103 W, in W 1/2 and NE 1/4 of section 15  
Dublin Ave. 5' E of monument 65' dip.

The above described Mining Claim shall be known as the

Wind #1

Date of discovery 28 Jan 1957  
Located this 18 day of Feb, 1957

DIAGRAM OF CLAIM

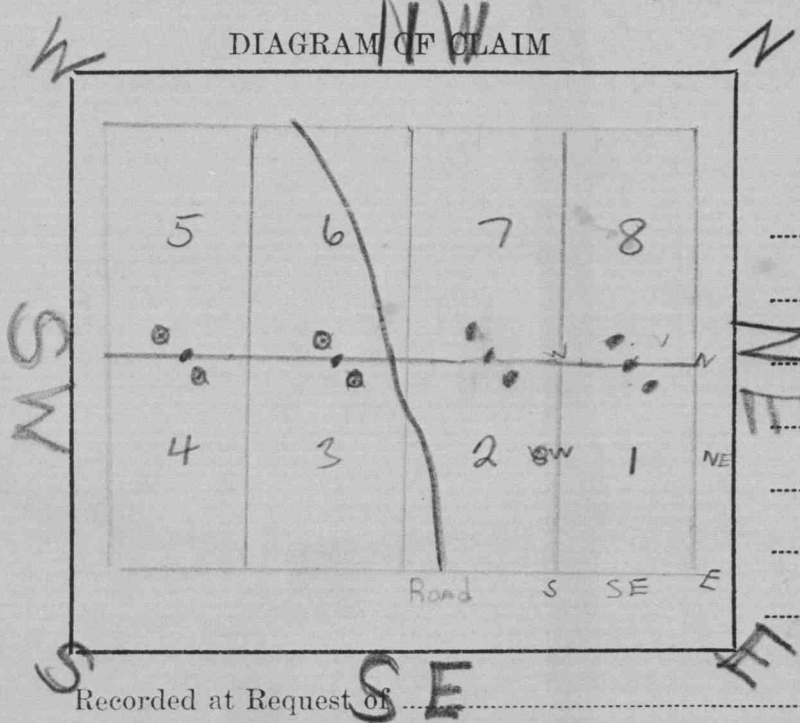

NAME OF LOCATORS:

Henry R Lent

Sworn to and subscribed before me this 29th day of March, 1957  
of Sublette County, Wyoming

Recorded at Request of SE  
at Sublette M. Fee Paid \$1.00  
by Henry R Lent Dept. Book 58657

Page 1 Ref.: 1957-16456 M  
IN BOOK 3A Location Sublette PAGE 313  
FEES \$ 1.00 Sublette COUNTY CLERK  
SUBLETTE COUNTY, PINEDALE, WYOMING

Sworn to Subscribed before me this 29th day of March, 1957